

NOTES:

- 1.) FOR MODELS : 75-11-M, 250 GPH
 75-11-F, 450 GPH
 75-11-H, 600 GPH
 75-11-C, 1000 GPH
 75-11-W, 1250 GPH
- 2.) APPROX. WEIGHT 24 LBS.

THIS PRINT IS AND CONTAINS PROPRIETARY INFORMATION OWNED EXCLUSIVELY BY SELLERS CLEANING SYSTEMS AND CLOUD TANK COMPANY. THIS RESTRICTION INCLUDES, BUT IS NOT LIMITED TO, THE CONDITION THAT THIS PRINT WILL ONLY BE USED AS A RECORD OR TO IDENTIFY OR INSPECT PARTS OR FOR OTHER INFORMATION PURPOSES, AND WILL NOT BE USED TO MANUFACTURE OR PROCURE THE MANUFACTURE OF THE PARTS SHOWN IN THIS PRINT BY ANY OTHER SOURCE THAN SELLERS CLEANING SYSTEMS AND CLOUD TANK COMPANY.

THIS DRAWING IS APPROVED FOR UNCONTROLLED DISTRIBUTION

AS A RESULT OF SELLERS CLEANING SYSTEMS CONSTANT PRODUCT IMPROVEMENT PROGRAM, PRODUCT CHANGES MAY OCCUR. AS SUCH, SELLERS CLEANING SYSTEMS RESERVES THE RIGHT TO CHANGE PRODUCT WITHOUT PRIOR WRITTEN NOTIFICATION

WWW.SELLERSCLEAN.COM SHEET 1 OF 7

TITLE		CAGE NO	
B JET INJECTORS		96046	
DWG NO	REV		
CD75-11	A		

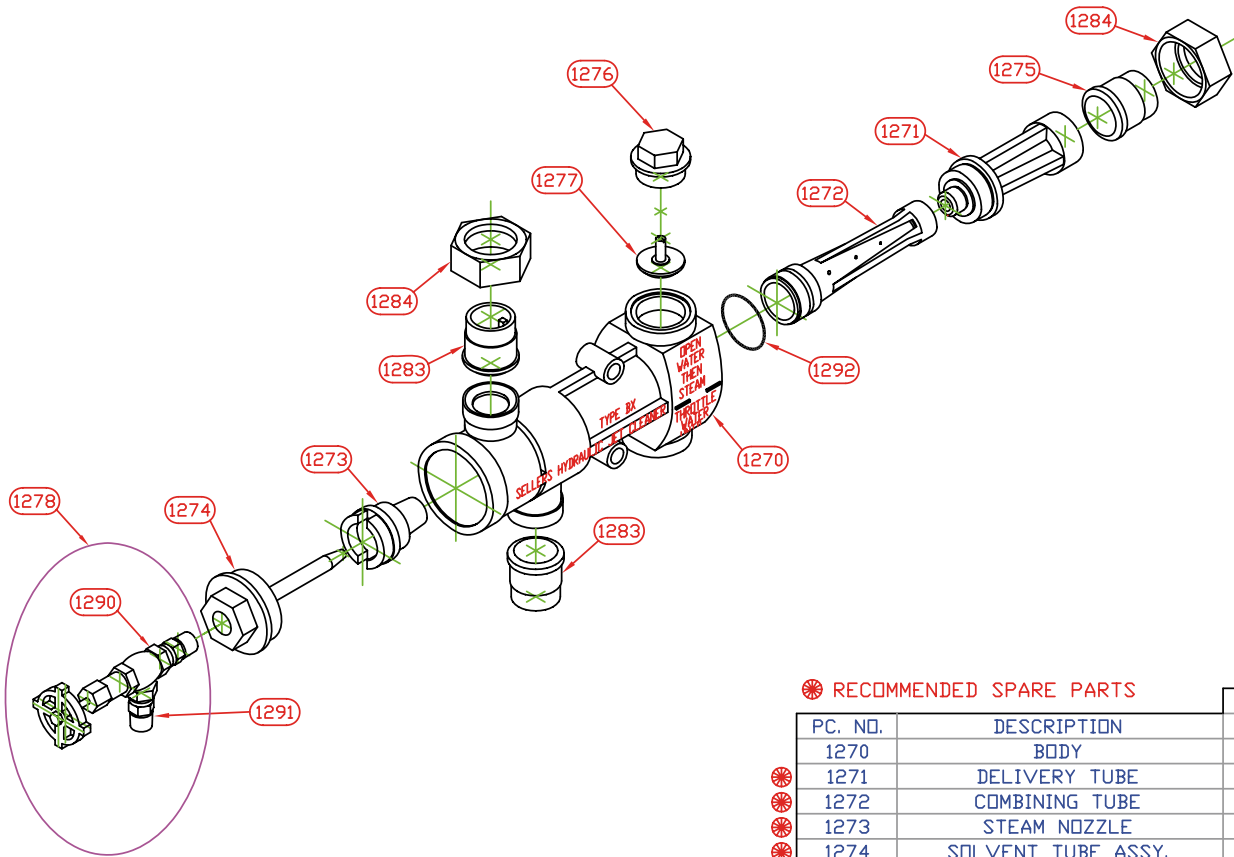

☼ RECOMMENDED SPARE PARTS

PC. NO.	DESCRIPTION	B-250	B-450	B-600	B-1000	B-1250
1270	BODY	75-11-M	75-11-F	75-11-H	75-11-C	75-11-W
☼ 1271	DELIVERY TUBE	75-389	75-390	75-114	75-115	75-116
☼ 1272	COMBINING TUBE	75-772	75-391	75-118	75-491	75-491
☼ 1273	STEAM NOZZLE	75-563	75-392	75-122	75-123	75-124
☼ 1274	SOLVENT TUBE ASSY.	75-126	75-126	75-126	75-127	75-127
1275	HOSE/PIPE UNION	75-135	75-135	75-135	75-135	75-135
1276	CAP OVER #1277	75-136	75-136	75-136	75-136	75-136
☼ 1277	OVERFLOW VALVE	75-137	75-137	75-137	75-137	75-137
1283	PIPE UNION	12-103	12-103	12-103	12-103	12-103
1284	COUPLING NUT	75-143	75-143	75-143	75-143	75-143
☼ 1278	SOLVENT CTRL. VALVE ASSY. (1290 & 1291 PART OF ASSY.)	75-920	75-920	75-920	75-920	75-920
1290	NEEDLE VALVE	75-916	75-916	75-916	75-916	75-916
1291	CHECK VALVE	75-917	75-917	75-917	75-917	75-917
☼ 1292	O-RING FOR COMB. TUBE	- - - - - 2-31052-216 - - - - -				

THIS PRINT IS AND CONTAINS PROPRIETARY INFORMATION OWNED EXCLUSIVELY BY SELLERS CLEANING SYSTEMS AND CLOUD TANK COMPANY. THIS RESTRICTION INCLUDES, BUT IS NOT LIMITED TO, THE CONDITION THAT THIS PRINT WILL ONLY BE USED AS A RECORD OR TO IDENTIFY OR INSPECT PARTS OR FOR OTHER INFORMATION PURPOSES, AND WILL NOT BE USED TO MANUFACTURE OR PROCURE THE MANUFACTURE OF THE PARTS SHOWN IN THIS PRINT BY ANY OTHER SOURCE THAN SELLERS CLEANING SYSTEMS AND CLOUD TANK COMPANY.

THIS DRAWING IS APPROVED FOR UNCONTROLLED DISTRIBUTION
 AS A RESULT OF SELLERS CLEANING SYSTEMS CONSTANT PRODUCT IMPROVEMENT PROGRAM, PRODUCT CHANGES MAY OCCUR. AS SUCH, SELLERS CLEANING SYSTEMS RESERVES THE RIGHT TO CHANGE PRODUCT WITHOUT PRIOR WRITTEN NOTIFICATION
 WWW.SELLERSCLEAN.COM SHEET 2 OF 7

TITLE		B JET INJECTORS		CAGE NO	96046
DWG NO	CD75-11	REV	A		

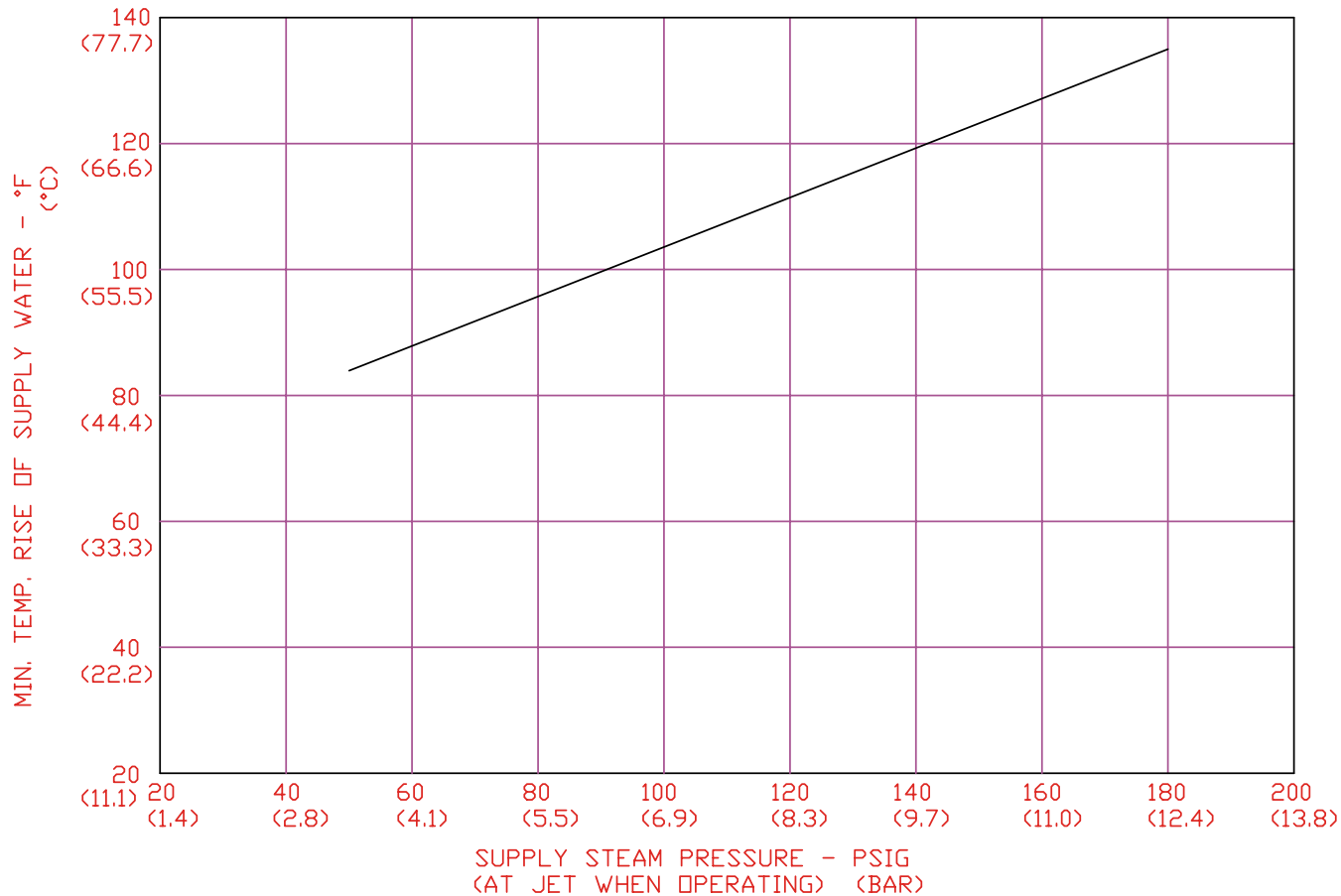

NOTE: JET DISCHARGE TEMP. = INPUT WATER TEMP. + TEMP. RISE

THIS PRINT IS AND CONTAINS PROPRIETARY INFORMATION OWNED EXCLUSIVELY BY SELLERS CLEANING SYSTEMS AND CLOUD TANK COMPANY. THIS RESTRICTION INCLUDES, BUT IS NOT LIMITED TO, THE CONDITION THAT THIS PRINT WILL ONLY BE USED AS A RECORD OR TO IDENTIFY OR INSPECT PARTS OR FOR OTHER INFORMATION PURPOSES, AND WILL NOT BE USED TO MANUFACTURE OR PROCURE THE MANUFACTURE OF THE PARTS SHOWN IN THIS PRINT BY ANY OTHER SOURCE THAN SELLERS CLEANING SYSTEMS AND CLOUD TANK COMPANY.

THIS DRAWING IS APPROVED FOR UNCONTROLLED DISTRIBUTION

AS A RESULT OF SELLERS CLEANING SYSTEMS CONSTANT PRODUCT IMPROVEMENT PROGRAM, PRODUCT CHANGES MAY OCCUR. AS SUCH, SELLERS CLEANING SYSTEMS RESERVES THE RIGHT TO CHANGE PRODUCT WITHOUT PRIOR WRITTEN NOTIFICATION

WWW.SELLERSCLEAN.COM

SHEET 3 OF 7

TITLE

B JET INJECTORS

CAGE NO

96046

DWG NO

CD75-11

REV

A

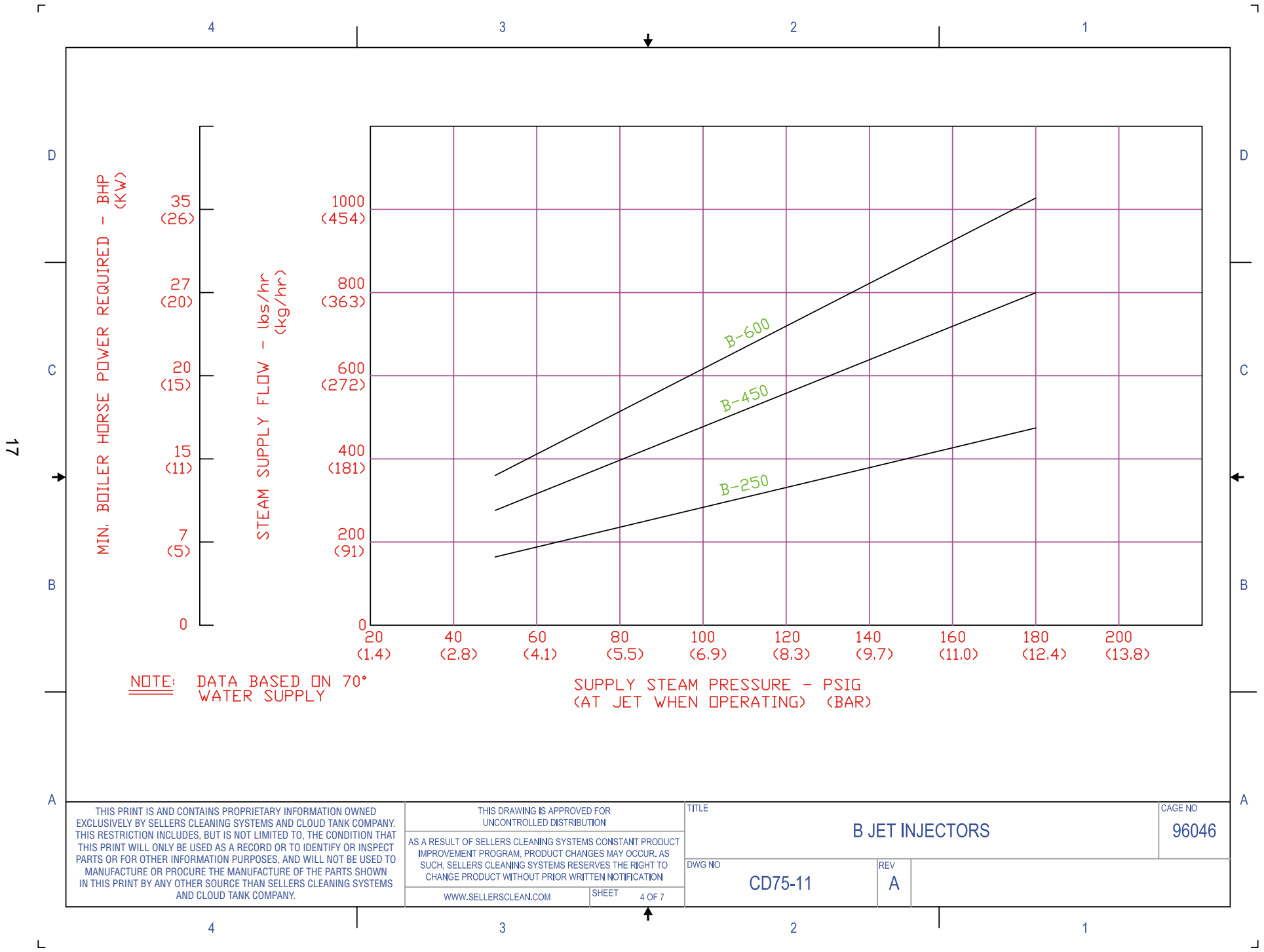

NOTE: DATA BASED ON 70° WATER SUPPLY

SUPPLY STEAM PRESSURE - PSIG
(AT JET WHEN OPERATING) (BAR)

THIS PRINT IS AND CONTAINS PROPRIETARY INFORMATION OWNED EXCLUSIVELY BY SELLERS CLEANING SYSTEMS AND CLOUD TANK COMPANY. THIS RESTRICTION INCLUDES, BUT IS NOT LIMITED TO, THE CONDITION THAT THIS PRINT WILL ONLY BE USED AS A RECORD OR TO IDENTIFY OR INSPECT PARTS OR FOR OTHER INFORMATION PURPOSES, AND WILL NOT BE USED TO MANUFACTURE OR PROCURE THE MANUFACTURE OF THE PARTS SHOWN IN THIS PRINT BY ANY OTHER SOURCE THAN SELLERS CLEANING SYSTEMS AND CLOUD TANK COMPANY.

THIS DRAWING IS APPROVED FOR UNCONTROLLED DISTRIBUTION

AS A RESULT OF SELLERS CLEANING SYSTEMS CONSTANT PRODUCT IMPROVEMENT PROGRAM, PRODUCT CHANGES MAY OCCUR. AS SUCH, SELLERS CLEANING SYSTEMS RESERVES THE RIGHT TO CHANGE PRODUCT WITHOUT PRIOR WRITTEN NOTIFICATION

WWW.SELLERSCLEAN.COM SHEET 4 OF 7

TITLE
B JET INJECTORS

DWG NO
CD75-11

REV
A

CAGE NO
96046

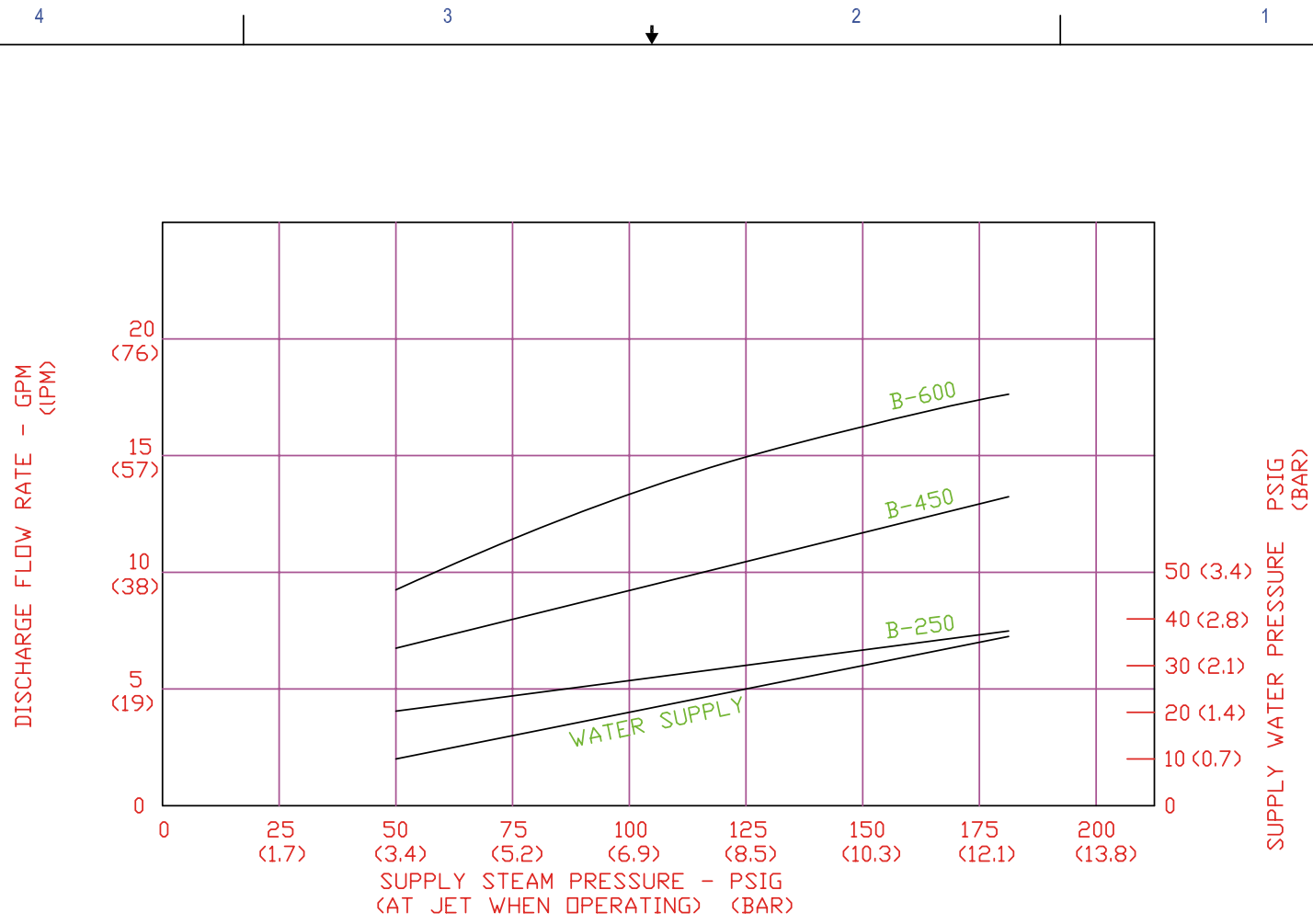

NOTE: DATA BASED ON 70°F SUPPLY WATER

THIS PRINT IS AND CONTAINS PROPRIETARY INFORMATION OWNED EXCLUSIVELY BY SELLERS CLEANING SYSTEMS AND CLOUD TANK COMPANY. THIS RESTRICTION INCLUDES, BUT IS NOT LIMITED TO, THE CONDITION THAT THIS PRINT WILL ONLY BE USED AS A RECORD OR TO IDENTIFY OR INSPECT PARTS OR FOR OTHER INFORMATION PURPOSES, AND WILL NOT BE USED TO MANUFACTURE OR PROCURE THE MANUFACTURE OF THE PARTS SHOWN IN THIS PRINT BY ANY OTHER SOURCE THAN SELLERS CLEANING SYSTEMS AND CLOUD TANK COMPANY.

THIS DRAWING IS APPROVED FOR UNCONTROLLED DISTRIBUTION
 AS A RESULT OF SELLERS CLEANING SYSTEMS CONSTANT PRODUCT IMPROVEMENT PROGRAM, PRODUCT CHANGES MAY OCCUR. AS SUCH, SELLERS CLEANING SYSTEMS RESERVES THE RIGHT TO CHANGE PRODUCT WITHOUT PRIOR WRITTEN NOTIFICATION
 WWW.SELLERSCLEAN.COM SHEET 5 OF 7

TITLE
B JET INJECTORS
 DWG NO
CD75-11
 REV
A

CAGE NO
96046

19

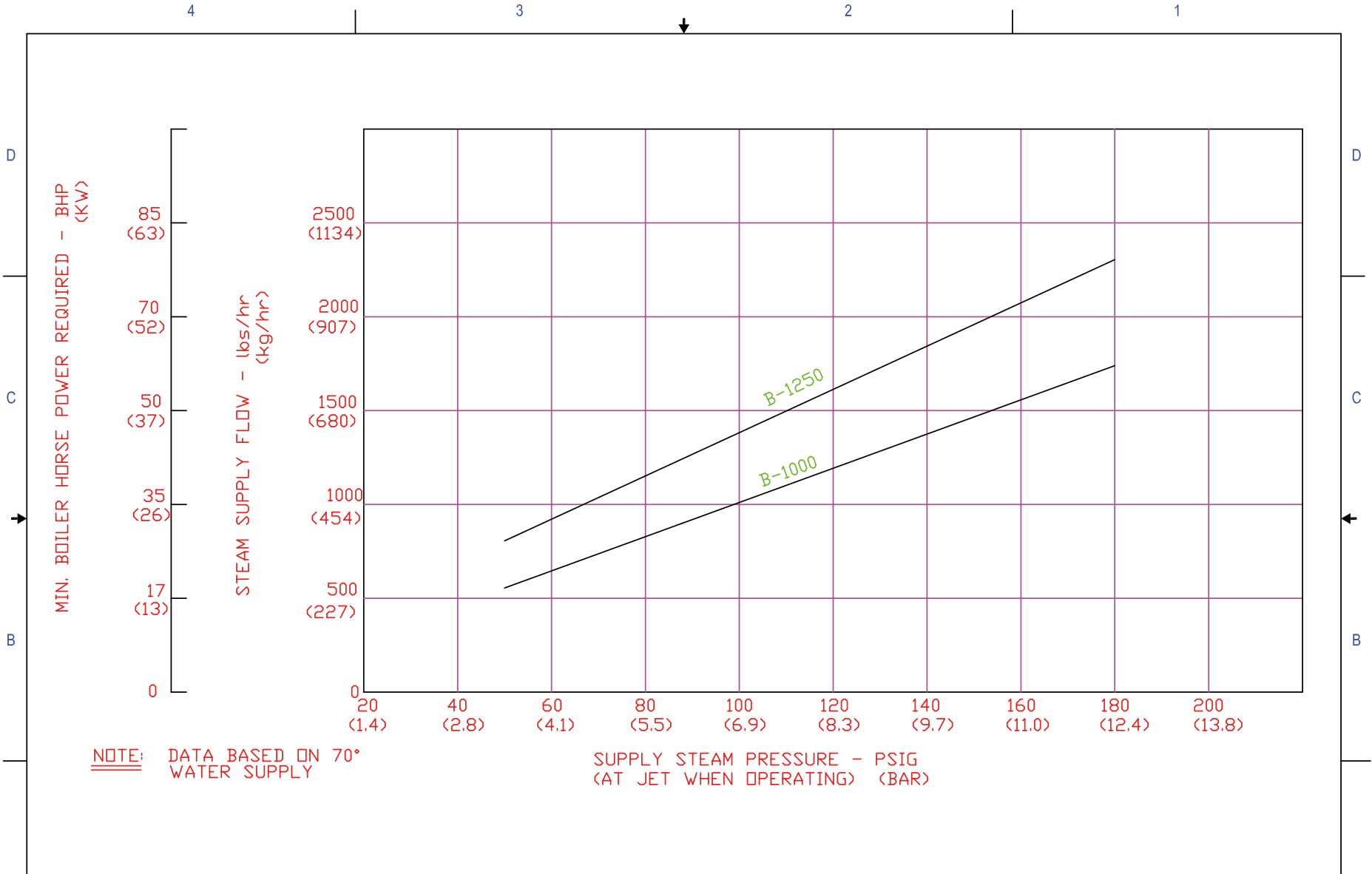

NOTE: DATA BASED ON 70° WATER SUPPLY

SUPPLY STEAM PRESSURE - PSIG
(AT JET WHEN OPERATING) (BAR)

<p>THIS PRINT IS AND CONTAINS PROPRIETARY INFORMATION OWNED EXCLUSIVELY BY SELLERS CLEANING SYSTEMS AND CLOUD TANK COMPANY. THIS RESTRICTION INCLUDES, BUT IS NOT LIMITED TO, THE CONDITION THAT THIS PRINT WILL ONLY BE USED AS A RECORD OR TO IDENTIFY OR INSPECT PARTS OR FOR OTHER INFORMATION PURPOSES, AND WILL NOT BE USED TO MANUFACTURE OR PROCURE THE MANUFACTURE OF THE PARTS SHOWN IN THIS PRINT BY ANY OTHER SOURCE THAN SELLERS CLEANING SYSTEMS AND CLOUD TANK COMPANY.</p>	<p>THIS DRAWING IS APPROVED FOR UNCONTROLLED DISTRIBUTION</p>		<p>TITLE B JET INJECTORS</p>		<p>CAGE NO 96046</p>
	<p>AS A RESULT OF SELLERS CLEANING SYSTEMS CONSTANT PRODUCT IMPROVEMENT PROGRAM, PRODUCT CHANGES MAY OCCUR. AS SUCH, SELLERS CLEANING SYSTEMS RESERVES THE RIGHT TO CHANGE PRODUCT WITHOUT PRIOR WRITTEN NOTIFICATION</p>		<p>DWG NO CD75-11</p>	<p>REV A</p>	
	<p>WWW.SELLERSCLEAN.COM</p>	<p>SHEET 6 OF 7</p>			

DISCHARGE FLOW RATE - GPM
(PM)

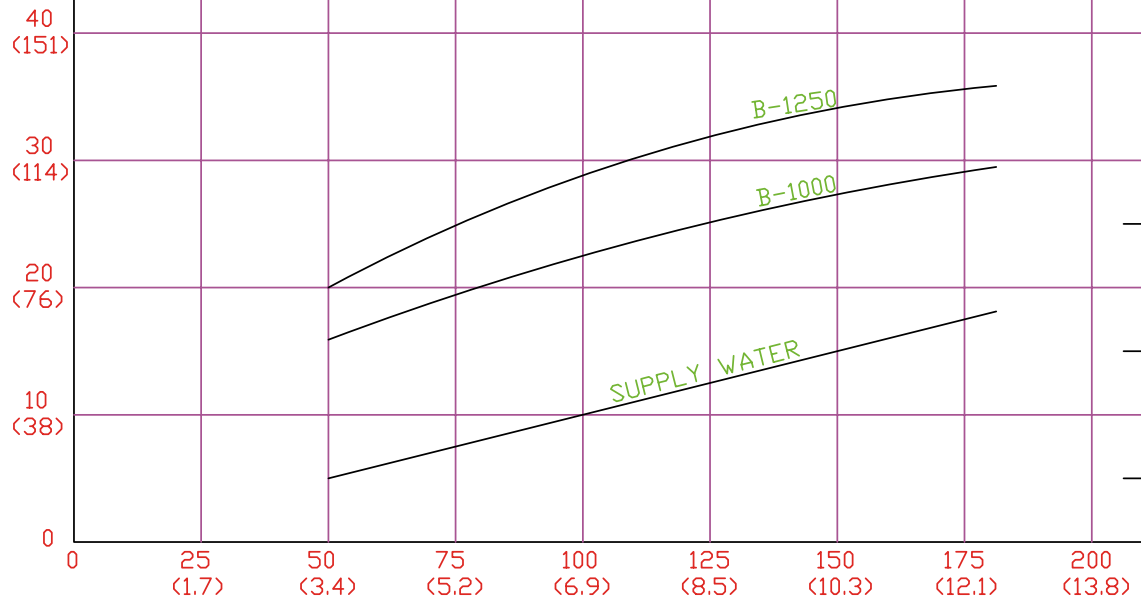

SUPPLY WATER PRESSURE PSIG
(BAR)

SUPPLY STEAM PRESSURE - PSIG
(AT JET WHEN OPERATING) (BAR)

NOTE: DATA BASED ON 70°F SUPPLY WATER

<p>THIS PRINT IS AND CONTAINS PROPRIETARY INFORMATION OWNED EXCLUSIVELY BY SELLERS CLEANING SYSTEMS AND CLOUD TANK COMPANY. THIS RESTRICTION INCLUDES, BUT IS NOT LIMITED TO, THE CONDITION THAT THIS PRINT WILL ONLY BE USED AS A RECORD OR TO IDENTIFY OR INSPECT PARTS OR FOR OTHER INFORMATION PURPOSES, AND WILL NOT BE USED TO MANUFACTURE OR PROCURE THE MANUFACTURE OF THE PARTS SHOWN IN THIS PRINT BY ANY OTHER SOURCE THAN SELLERS CLEANING SYSTEMS AND CLOUD TANK COMPANY.</p>	<p>THIS DRAWING IS APPROVED FOR UNCONTROLLED DISTRIBUTION</p>		<p>TITLE B JET INJECTORS</p>		<p>CAGE NO 96046</p>
	<p>AS A RESULT OF SELLERS CLEANING SYSTEMS CONSTANT PRODUCT IMPROVEMENT PROGRAM, PRODUCT CHANGES MAY OCCUR. AS SUCH, SELLERS CLEANING SYSTEMS RESERVES THE RIGHT TO CHANGE PRODUCT WITHOUT PRIOR WRITTEN NOTIFICATION</p>		<p>DWG NO CD75-11</p>	<p>REV A</p>	
	<p>WWW.SELLERSCLEAN.COM</p>	<p>SHEET 7 OF 7</p>			

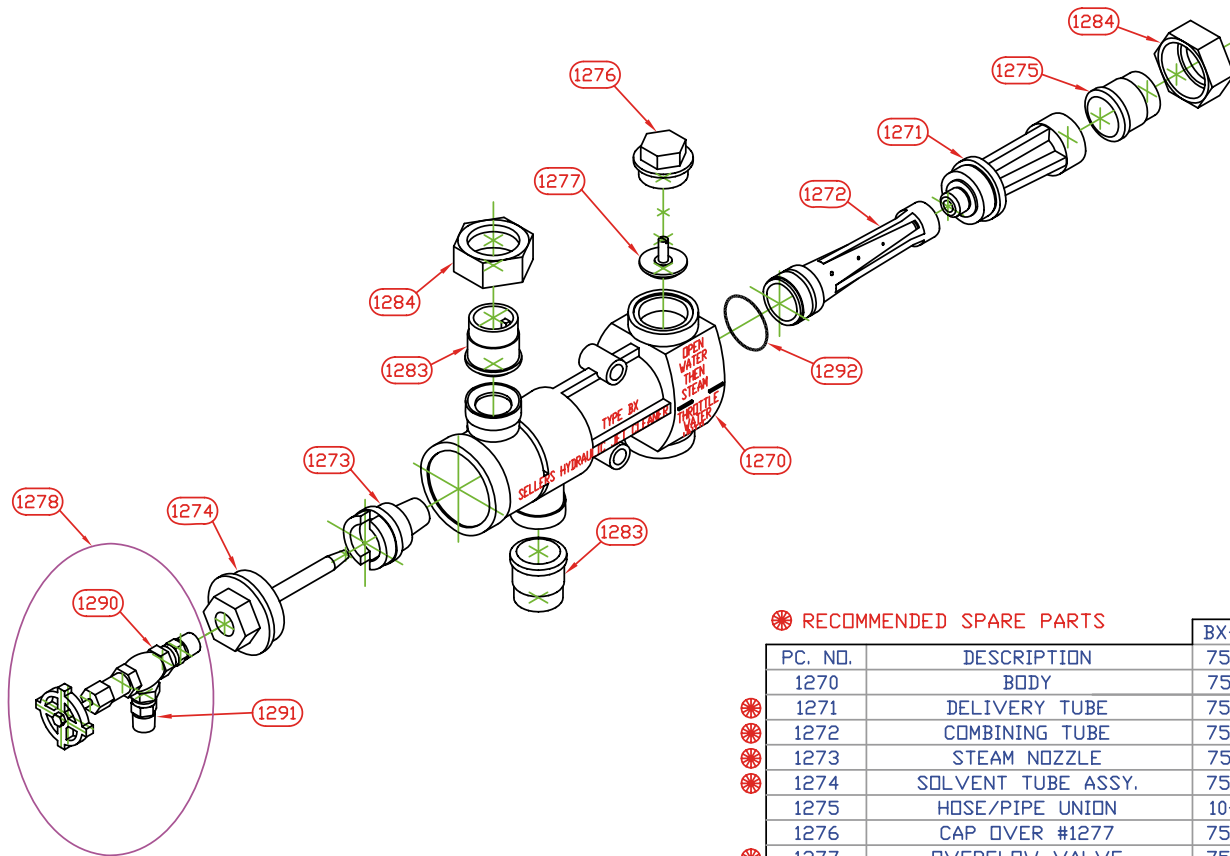

☼ RECOMMENDED SPARE PARTS

PC. NO.	DESCRIPTION	BX-2000	BX-3000	BX-4000
1270	BODY	75-7-J	75-7-K	75-7-L
☼ 1271	DELIVERY TUBE	75-780	75-780	75-780
☼ 1272	COMBINING TUBE	75-789	75-786	75-782
☼ 1273	STEAM NOZZLE	75-790	75-787	75-783
☼ 1274	SOLVENT TUBE ASSY.	75-784	75-784	75-784
1275	HOSE/PIPE UNION	10-327	10-327	10-327
1276	CAP OVER #1277	75-798	75-798	75-798
☼ 1277	OVERFLOW VALVE	75-797	75-797	75-797
1283	PIPE UNION	10-327	10-327	10-327
1284	COUPLING NUT	76-124	76-124	76-124
☼ 1278	SOLVENT CTRL. VALVE ASSY. (1290 & 1291 PART OF ASSY.)	75-920	75-920	75-920
1290	NEEDLE VALVE	75-916	75-916	75-916
1291	CHECK VALVE	75-917	75-917	75-917
☼ 1292	O-RING FOR COMB. TUBE	--	2-31052-225	--

THIS PRINT IS AND CONTAINS PROPRIETARY INFORMATION OWNED EXCLUSIVELY BY SELLERS CLEANING SYSTEMS AND CLOUD TANK COMPANY. THIS RESTRICTION INCLUDES, BUT IS NOT LIMITED TO, THE CONDITION THAT THIS PRINT WILL ONLY BE USED AS A RECORD OR TO IDENTIFY OR INSPECT PARTS OR FOR OTHER INFORMATION PURPOSES, AND WILL NOT BE USED TO MANUFACTURE OR PROCURE THE MANUFACTURE OF THE PARTS SHOWN IN THIS PRINT BY ANY OTHER SOURCE THAN SELLERS CLEANING SYSTEMS AND CLOUD TANK COMPANY.

THIS DRAWING IS APPROVED FOR UNCONTROLLED DISTRIBUTION
 AS A RESULT OF SELLERS CLEANING SYSTEMS CONSTANT PRODUCT IMPROVEMENT PROGRAM, PRODUCT CHANGES MAY OCCUR. AS SUCH, SELLERS CLEANING SYSTEMS RESERVES THE RIGHT TO CHANGE PRODUCT WITHOUT PRIOR WRITTEN NOTIFICATION
 WWW.SELLERSCLEAN.COM SHEET 2 OF 5

TITLE		CAGE NO	
BX JET INJECTORS		96046	
DWG NO	REV		
CD75-7	A		

C	4-585-87 REDRAWN	6/25/87	TEK
D	00490-94 REDRAWN TO CAD	6/14/94	DAG
E	00721-94 REV. SOLVENT VALVE	10/31/94	

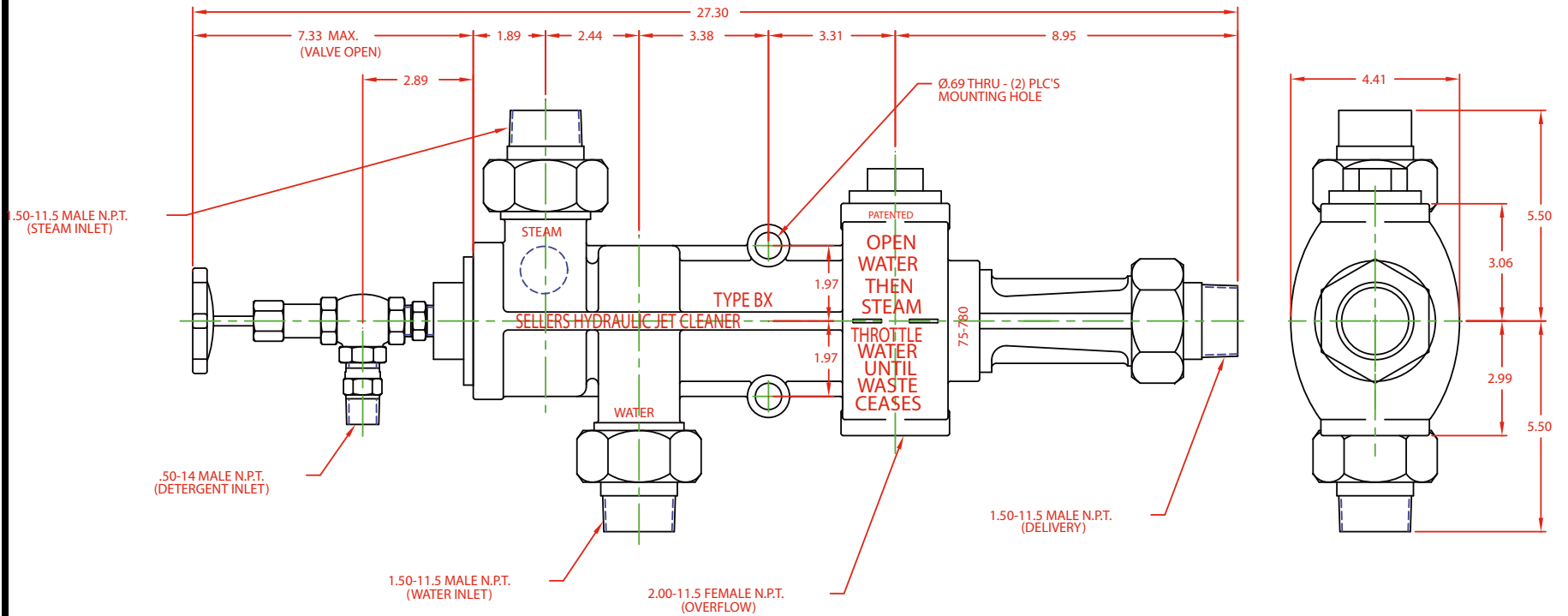
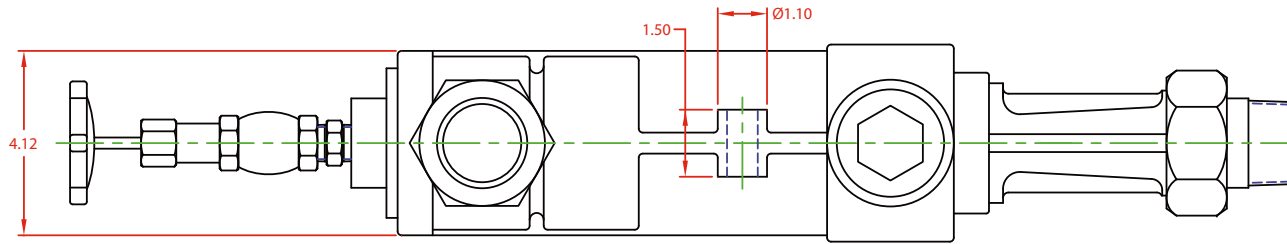

NOTES:

- 1) FOR MODELS: 75-7-J, 2000 GPH
75-7-K, 3000 GPH
75-7-L, 4000 GPH

- 2) APPROX. WEIGHT 48 LBS.

KIRK NEER 6/14/94

INJECTOR, ASSEMBLY "BX" JET

75-7-X

4 3 2 1

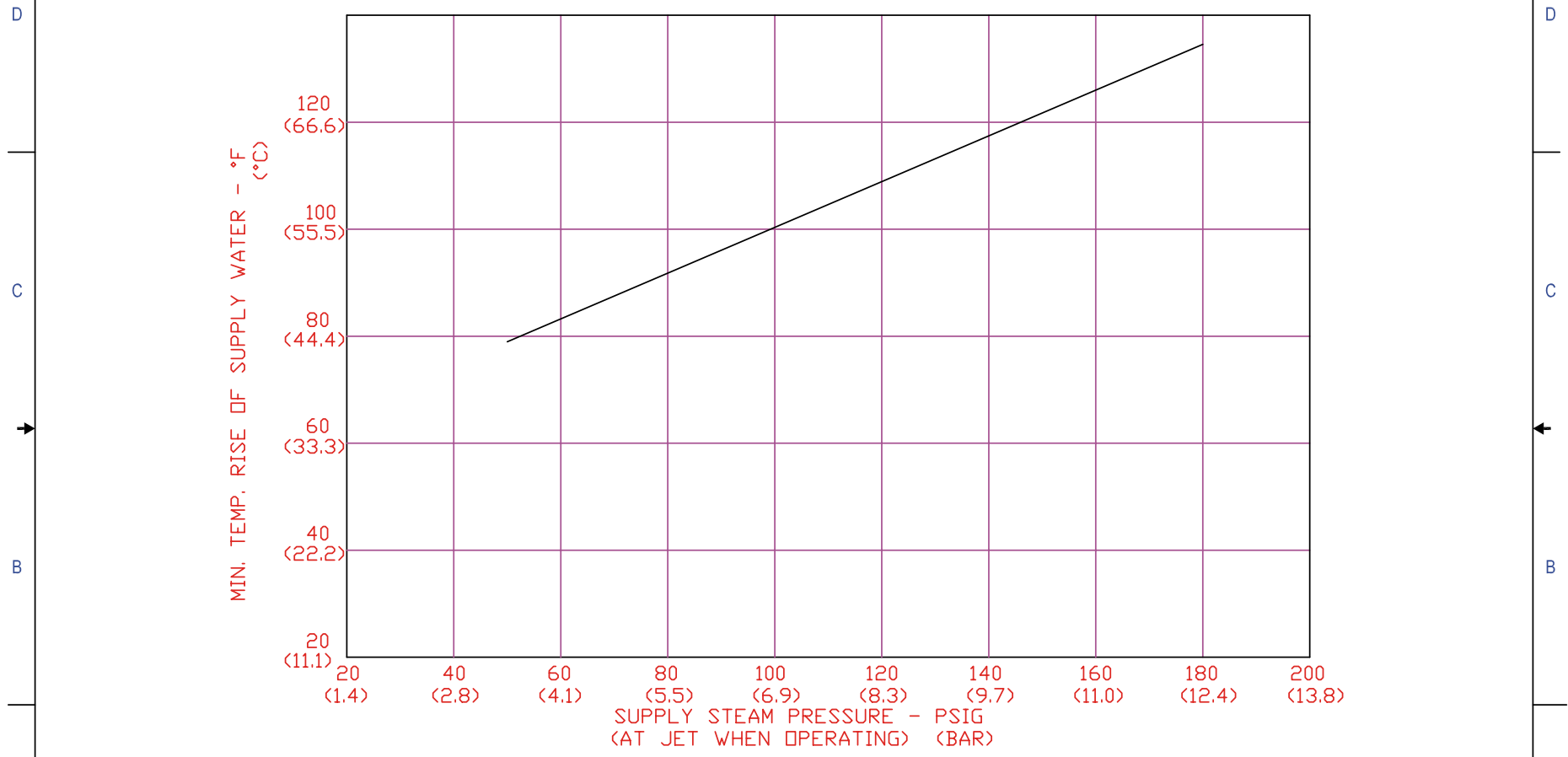

NOTE: JET DISCHARGE TEMP. = INPUT WATER TEMP. + TEMP. RISE

23

<p>THIS PRINT IS AND CONTAINS PROPRIETARY INFORMATION OWNED EXCLUSIVELY BY SELLERS CLEANING SYSTEMS AND CLOUD TANK COMPANY. THIS RESTRICTION INCLUDES, BUT IS NOT LIMITED TO, THE CONDITION THAT THIS PRINT WILL ONLY BE USED AS A RECORD OR TO IDENTIFY OR INSPECT PARTS OR FOR OTHER INFORMATION PURPOSES, AND WILL NOT BE USED TO MANUFACTURE OR PROCURE THE MANUFACTURE OF THE PARTS SHOWN IN THIS PRINT BY ANY OTHER SOURCE THAN SELLERS CLEANING SYSTEMS AND CLOUD TANK COMPANY.</p>	<p>THIS DRAWING IS APPROVED FOR UNCONTROLLED DISTRIBUTION</p>	<p>TITLE BX JET INJECTORS</p>		<p>CAGE NO 96046</p>	
	<p>AS A RESULT OF SELLERS CLEANING SYSTEMS CONSTANT PRODUCT IMPROVEMENT PROGRAM, PRODUCT CHANGES MAY OCCUR. AS SUCH, SELLERS CLEANING SYSTEMS RESERVES THE RIGHT TO CHANGE PRODUCT WITHOUT PRIOR WRITTEN NOTIFICATION</p>	<p>DWG NO CD75-7</p>	<p>REV A</p>		
	<p>WWW.SELLERSCLEAN.COM</p>	<p>SHEET 3 OF 5</p>			

4 3 2 1

24

MIN. BOILER HORSE POWER REQUIRED BHP (KW)

STEAM FLOW x 1000 - (lbs/hr) (kg/hr)

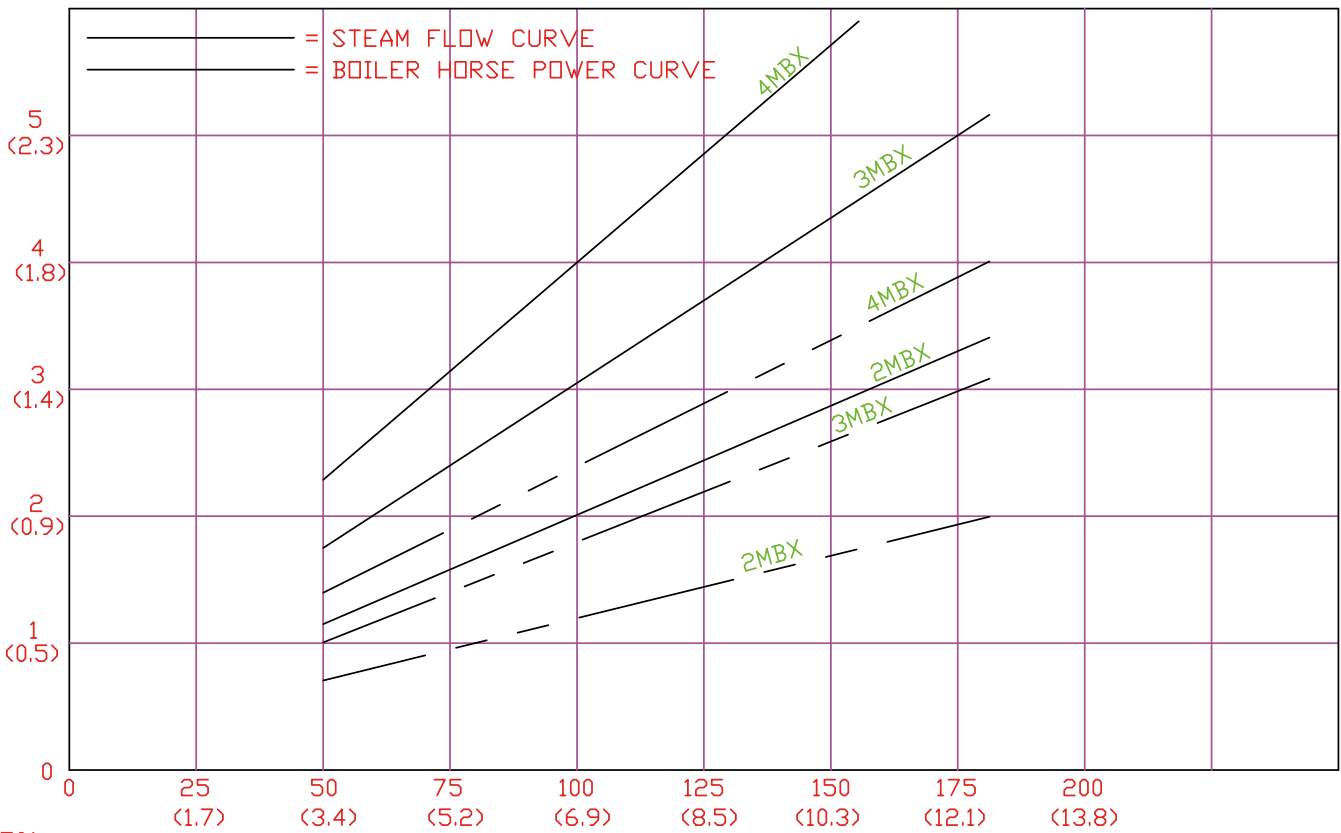

NOTE: DATA BASED ON 70° WATER SUPPLY

SUPPLY STEAM PRESSURE - PSIG (AT JET WHEN OPERATING) (BAR)

THIS PRINT IS AND CONTAINS PROPRIETARY INFORMATION OWNED EXCLUSIVELY BY SELLERS CLEANING SYSTEMS AND CLOUD TANK COMPANY. THIS RESTRICTION INCLUDES, BUT IS NOT LIMITED TO, THE CONDITION THAT THIS PRINT WILL ONLY BE USED AS A RECORD OR TO IDENTIFY OR INSPECT PARTS OR FOR OTHER INFORMATION PURPOSES, AND WILL NOT BE USED TO MANUFACTURE OR PROCURE THE MANUFACTURE OF THE PARTS SHOWN IN THIS PRINT BY ANY OTHER SOURCE THAN SELLERS CLEANING SYSTEMS AND CLOUD TANK COMPANY.

THIS DRAWING IS APPROVED FOR UNCONTROLLED DISTRIBUTION

AS A RESULT OF SELLERS CLEANING SYSTEMS CONSTANT PRODUCT IMPROVEMENT PROGRAM, PRODUCT CHANGES MAY OCCUR. AS SUCH, SELLERS CLEANING SYSTEMS RESERVES THE RIGHT TO CHANGE PRODUCT WITHOUT PRIOR WRITTEN NOTIFICATION

WWW.SELLERSCLEAN.COM

SHEET 4 OF 5

TITLE

BX JET INJECTORS

CAGE NO

96046

DWG NO

CD75-7

REV

A

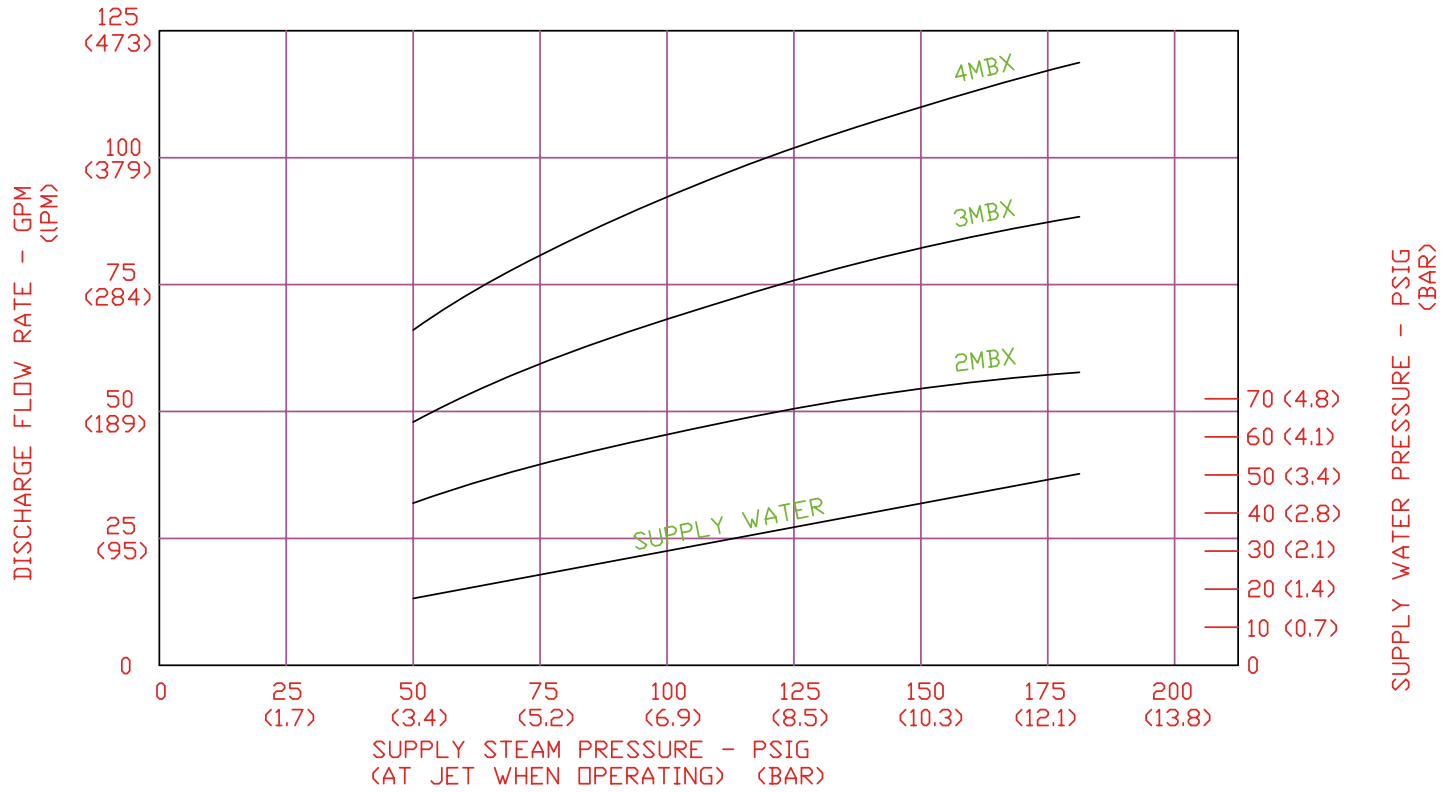

NOTE: DATA BASED ON 70°F SUPPLY WATER

THIS PRINT IS AND CONTAINS PROPRIETARY INFORMATION OWNED EXCLUSIVELY BY SELLERS CLEANING SYSTEMS AND CLOUD TANK COMPANY. THIS RESTRICTION INCLUDES, BUT IS NOT LIMITED TO, THE CONDITION THAT THIS PRINT WILL ONLY BE USED AS A RECORD OR TO IDENTIFY OR INSPECT PARTS OR FOR OTHER INFORMATION PURPOSES, AND WILL NOT BE USED TO MANUFACTURE OR PROCURE THE MANUFACTURE OF THE PARTS SHOWN IN THIS PRINT BY ANY OTHER SOURCE THAN SELLERS CLEANING SYSTEMS AND CLOUD TANK COMPANY.

THIS DRAWING IS APPROVED FOR UNCONTROLLED DISTRIBUTION

AS A RESULT OF SELLERS CLEANING SYSTEMS CONSTANT PRODUCT IMPROVEMENT PROGRAM, PRODUCT CHANGES MAY OCCUR. AS SUCH, SELLERS CLEANING SYSTEMS RESERVES THE RIGHT TO CHANGE PRODUCT WITHOUT PRIOR WRITTEN NOTIFICATION

WWW.SELLERSCLEAN.COM

SHEET 5 OF 5

TITLE

BX JET INJECTORS

CAGE NO

96046

DWG NO

CD75-7

REV

A